

V1200/80
peso: 173.8 g

V1200/60
peso: 115.2 g

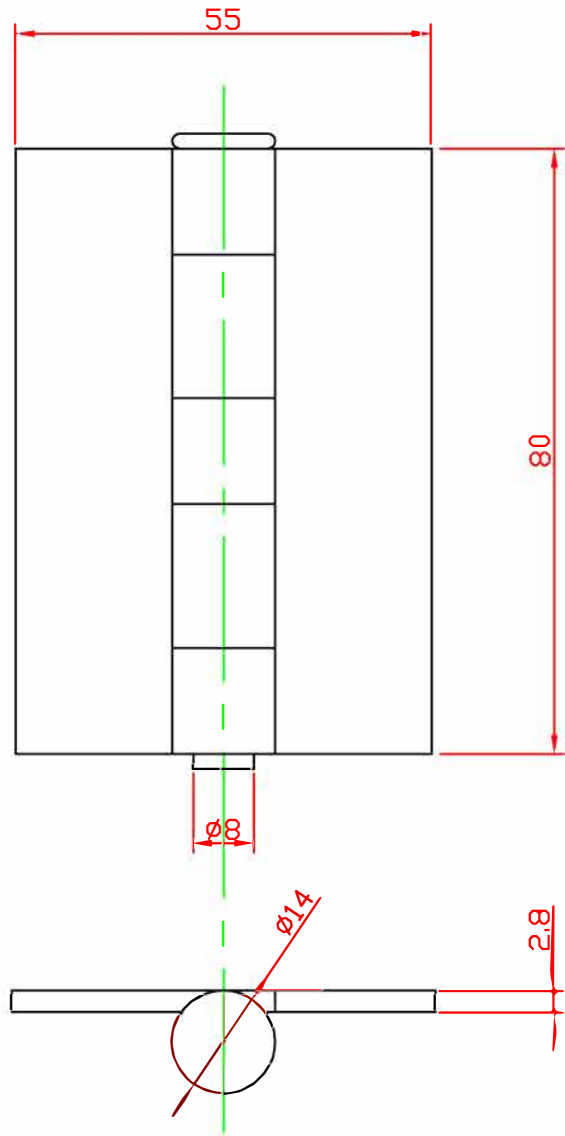
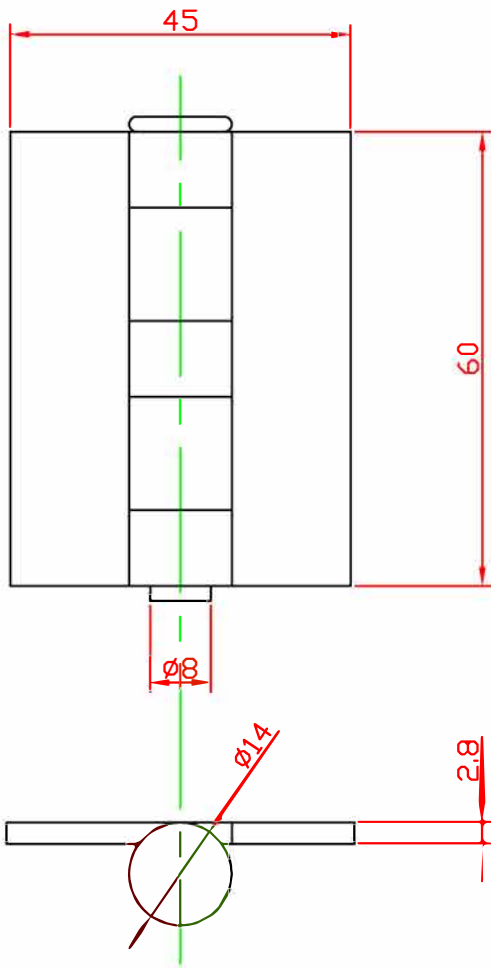

METALY

Prodotto

ART. V1200
CERNIERA PER SERRAMENTI A
SALDARE

Componente

Materiale:
DC01+C340

Finitura:
Grezzo

Peso:

Scala:
1:1

Data:
17/03/2016

File:
1200