

V1200/120
peso: 375 g

V1200/100
peso: 258 g

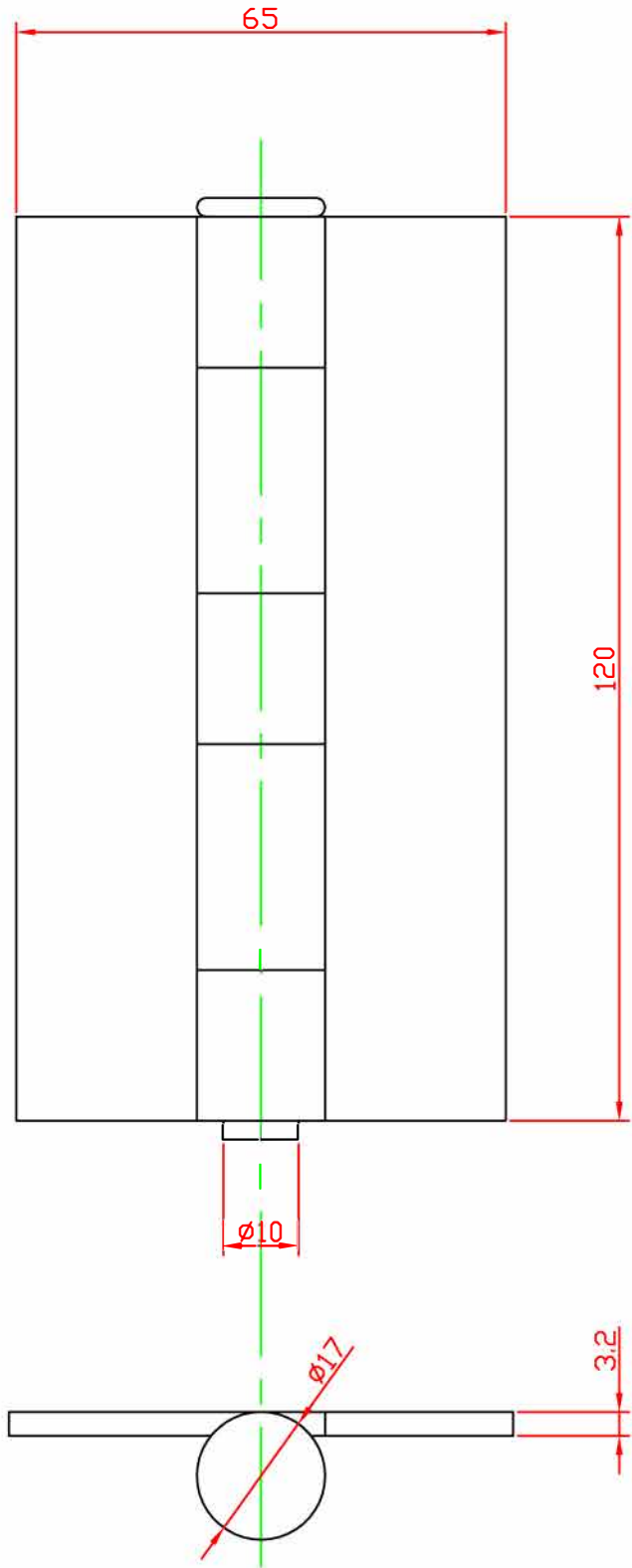
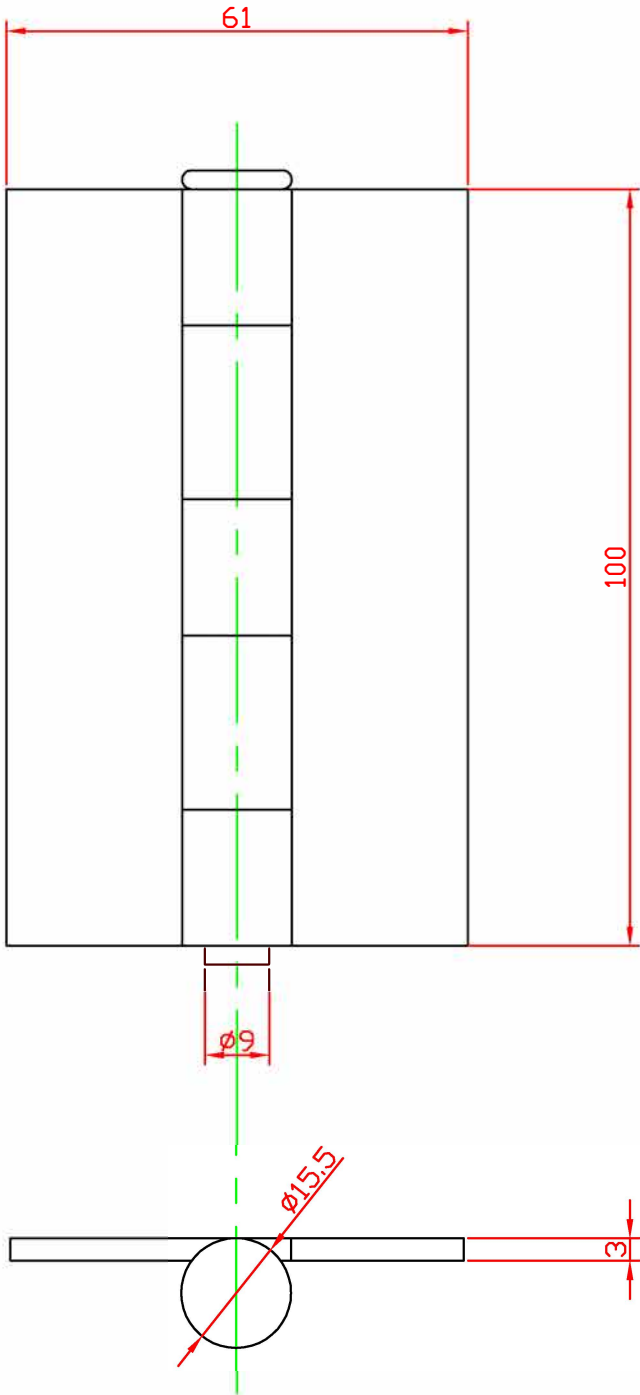

METALY

Prodotto

ART. V1200
CERNIERA PER SERRAMENTI A
SALDARE

Componente

Materiale:
DC01+C340

Peso:

Data:

17/03/2016

Finitura:
Grezzo

Scala:
1:1

File:
1200